

Size	1/4"	3/8"	1/2"	3/4"	1"	1 1/4"	1 1/2"	2"	2 1/2"	3"	4"
d	.17	.24	.32	.47	.55	.75	1.02	1.26	1.50	2.44	3.07
L	1.57	1.77	2.17	2.44	2.84	3.23	3.5	4.13	4.65	6.18	6.97
H	.87	1.02	2.24	2.36	2.64	2.8	3.07	3.35	2.83	4.65	5.20
W	3.15	3.15	4.61	4.65	5.24	5.79	5.47	6.38	7.09	9.25	9.25

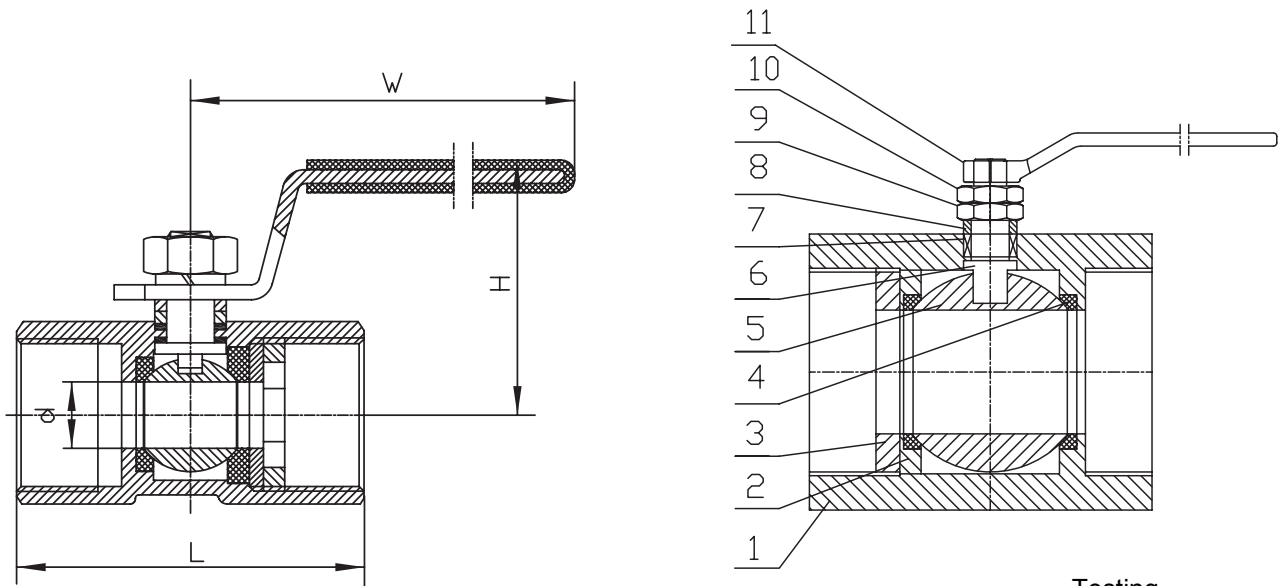

Testing  
 MSS-SP72  
 End Connection  
 NACE MRO 175

**Materials**

1	Body	216WCB/A105
2	Washer	216WCB
3	Seat-Nuts	216WCB
4	Seat	RTFE/PTFE
5	Ball	304SS / 316SS
6	Stem	304SS / 316SS
7	Sealing	PTFE
8	Packing	RTFE/PTFE
9	Nuts	216WCB
10	Nuts	216WCB
11	Handle	304SS

**Torque in/lbs**

Size	2000lb
1/4"	54
3/8"	80
1/2"	124
3/4"	195
1"	284
1 1/4"	399
1 1/2"	549
2"	841
2 1/2"	1001
3"	1240
4"	1487

Size	2000lb	
	Weight	Cv
1/4"	0.24	4
3/8"	0.4	4
1/2"	0.75	10
3/4"	1.19	30
1"	2.09	49
1 1/4"	3.08	100
1 1/2"	3.74	132
2"	6.12	171
2 1/2"	12.87	220
3"	22.44	295
4"	42.9	498

VALVE SIZE		DIMENSIONAL DATA SHEET		PART NO.	
PRESSURE RATING		<b>BALL VALVE</b> <b>SERIES 60</b> <b>SIZES 1/4" - 4"</b>		DRAWING NO.	
CUSTOMER/PROJECT				FL60-002	
INQ/PO NO.				REV	
ORDER NO.				A	
CERTIFIED BY				DATE	
DATE		7/09			

**Flow Line Valve and Controls, Inc.**