

VALVE SIZE	Z	Y	X	W	V	U	T	S	R	Q	P	TOP PLATE DRILLING					WGT. (LB)
												K1	K2	#holes	J1	J2	
2	1.74	2.25	2.65	1.46	5.62	8.44	4.12	4.00	.827	.44	.551	2.76	3.25	4	.39	.41	6
2-1/2	1.86	2.81	3.15	2.14	6.12	9.19	4.88	4.00	.827	.44	.551	2.76	3.25	4	.39	.41	7
3	1.86	3.31	3.78	2.74	6.38	9.69	5.38	4.00	.827	.44	.551	2.76	3.25	4	.39	.41	8
4	2.11	4.19	4.78	3.60	7.12	11.00	6.88	4.00	.827	.44	.551	2.76	3.25	4	.39	.41	12
5	2.24	5.06	5.84	4.58	7.75	12.12	7.75	4.00	1.063	.44	.670	2.76	3.25	4	.39	.41	15
6	2.24	6.06	7.03	5.62	8.25	13.25	8.75	4.00	1.063	.44	.670	2.76	3.25	4	.39	.41	18
8	2.54	7.94	8.96	7.43	9.44	15.56	11.00	6.00	1.063	.56	.866	4.02	5.00	4	.53	.53	29
10	2.74	10.00	11.09	9.38	11.25	18.69	13.38	6.00	1.063	.56	.866	4.02	5.00	4	.53	.53	43
12	3.24	11.94	13.09	11.35	12.19	21.69	16.12	6.00	1.063	.56	.866	4.02	5.00	4	.53	.53	71

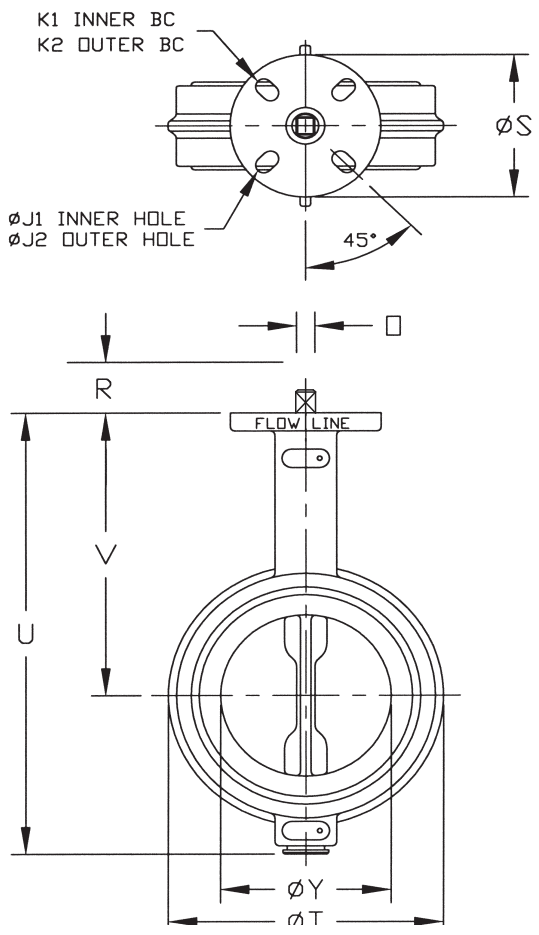

NOTE: W IS DISC CHORDAL DIMENSION AT VALVE FACE  
 ALL DIMENSIONS ARE INCHES

4	STEM		
3	DISC		
2	SEAT		
1	BODY		
ITEM	DESCRIPTION	MATERIAL	REMARKS

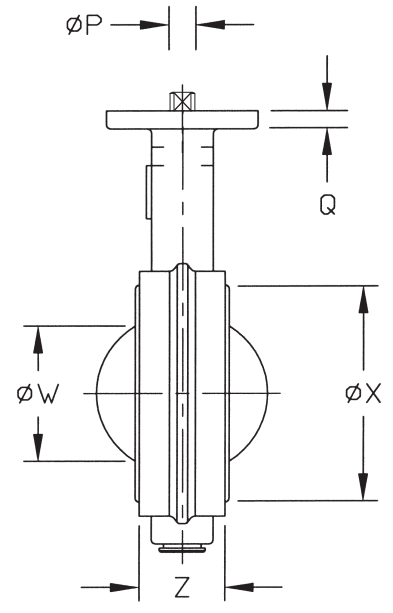

VALVE SIZE	FLANGE DRILLING	DIMENSIONAL DATA SHEET		PART NO.	
PRESSURE RATING		<b>BUTTERFLY VALVE</b> <b>SERIES 70</b> <b>SIZES 2"-12"</b>		DRAWING NO.	
CUSTOMER/PROJECT				70-001	REV
INQ./PO NO.					B
ORDER NO.				DATE	
CERTIFIED BY	DATE			6/09	