

VALVE SIZE	Z	Y	X	W	V	U	T	S	R	Q	P	TOP PLATE DRILLING					WGT. (LBS.)
												K1	K2	#holes	J1	J2	
2	1.66	2.01	3.00	1.24	5.62	8.44	4.12	4.00	.827	.44	.551	2.76	3.25	4	.39	.41	6
2½	1.76	2.47	3.50	1.82	6.12	9.19	4.88	4.00	.827	.44	.551	2.76	3.25	4	.39	.41	7
3	1.78	3.04	4.09	2.54	6.38	9.69	5.38	4.00	.827	.44	.551	2.76	3.25	4	.39	.41	8
4	2.05	4.00	5.31	3.54	7.12	11.00	6.88	4.00	.827	.44	.551	2.76	3.25	4	.39	.41	12
5	2.14	4.80	6.26	4.36	7.75	12.12	7.75	4.00	1.063	.44	.670	2.76	3.25	4	.39	.41	15
6	2.19	6.07	7.42	5.72	8.25	13.25	8.75	4.00	1.063	.44	.670	2.76	3.25	4	.39	.41	18
8	2.39	7.91	9.38	7.60	9.44	15.56	11.00	6.00	1.063	.56	.866	4.02	5.00	4	.59	.53	29
10	2.58	9.80	11.51	9.51	11.28	18.69	13.38	6.00	1.063	.56	.866	4.02	5.00	4	.59	.53	43
12	3.03	11.81	13.55	11.48	12.19	21.69	16.12	6.00	1.063	.56	.866	4.02	5.00	4	.59	.53	71

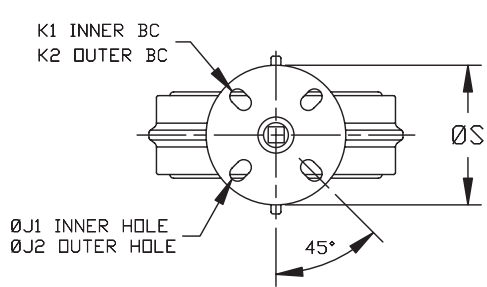

NOTE: W IS DISC CHORDAL DIMENSION AT VALVE FACE
 ALL DIMENSIONS ARE INCHES

4	STEM		
3	DISC		
2	SEAT		
1	BODY		
ITEM	DESCRIPTION	MATERIAL	REMARKS

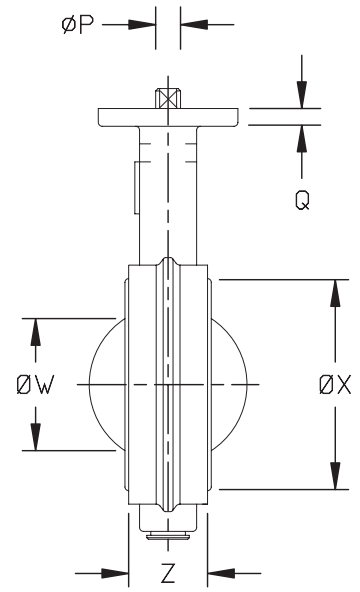
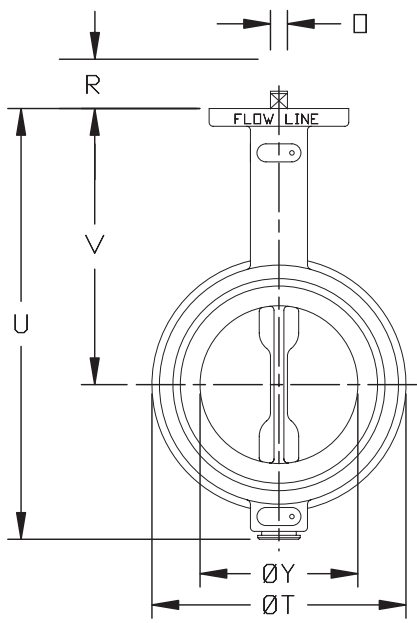

VALVE SIZE	FLANGE DRILLING	DIMENSIONAL DATA SHEET BUTTERFLY VALVE SERIES 72 SIZES 2"-12"		PART NO.	
PRESSURE RATING				DRAWING NO.	REV
CUSTOMER/PROJECT				72-001	B
INQ./PO NO.				DATE	
ORDER NO.				6/09	
CERTIFIED BY	DATE				