

Size	L	D	D1	D2	n-Ød	H	H1	h	K	ISO5211	d1	d2	d3	h1
8"	9.06	16.50	13.75	11.06	12-Ø1.26	9.29	28.15	4.33±.39	1.42	F25	11.81	10.00	7.87	0.20
10"	9.84	20.00	17.00	13.19	16-Ø1.42	11.02	30.12	4.33±.39	1.42	F25	11.81	10.00	7.87	0.20
12"	10.63	22.01	19.25	15.43	20-Ø1.42	12.13	34.25	4.72±.39	1.81	F25	11.81	10.00	7.87	0.20
14"	11.42	23.78	20.75	16.69	20-Ø1.54	12.99	36.22	6.30±.39	2.17	F25	11.81	10.00	7.87	0.20
16"	12.20	27.01	23.75	18.94	20-Ø1.65	14.61	38.19	6.30±.39	2.17	F25	11.81	10.00	7.87	0.20
18"	12.99	29.25	25.75	21.42	20-Ø1.77	15.87	40.55	6.69±.39	2.17	F25	11.81	10.00	7.87	0.20
20"	13.78	32.01	28.50	23.43	24-Ø1.77	17.40	42.52	6.69±.39	2.95	F30	13.78	11.73	9.06	0.20
24"	15.35	37.01	33.00	27.68	24-Ø2.01	19.88	44.49	7.48±.39	2.95	F35	16.34	14.02	10.24	0.20

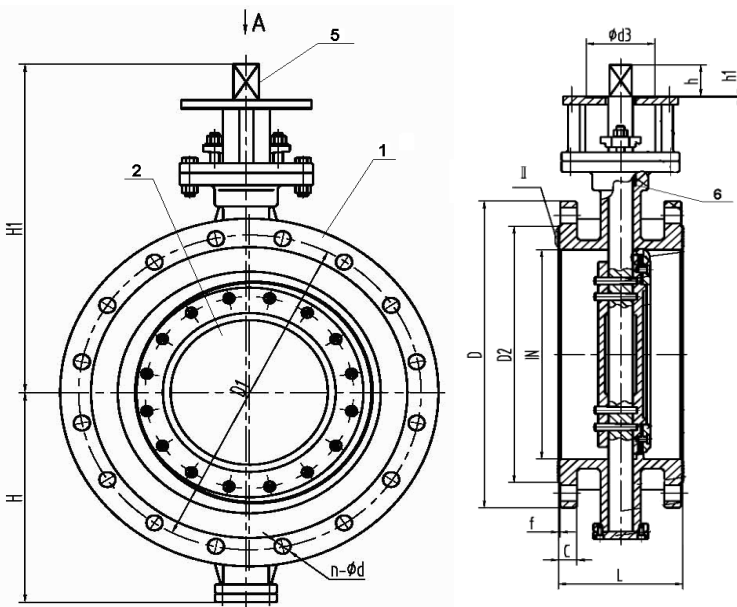

No.	Item	Material	Optional
1	Body	WCB/316SS/304SS	Duplex
2	Disc	316SS/304SS	Stellite/Duplex
3	Seat	.13Cr	Stellite
4	Seat Ring	316SS+Graphoil	Stellite+Graphoil/ 304SS+Graphoil/ .13Cr+Graphoil
5	Shaft	17-4PhSS	316SS/Monel
6	Packing	Graphoil	Consult Factory
7	Bearings	SS+Nitrate	Consult Factory

Design	API 607 6th Edition		
Flange	ANSI B16.5		
Test	API 598		
Torque In-lbs			
8"	47795	16"	167921
10"	61603	18"	270291
12"	74348	20"	403606
14"	100759	24"	584166

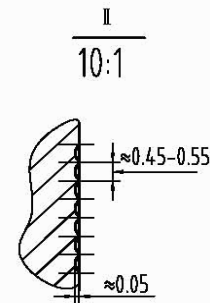
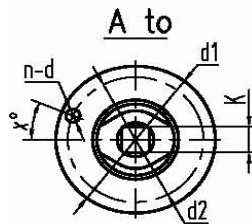
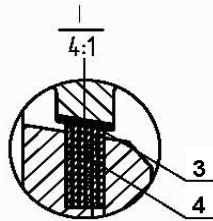

VALVE Flanged Torque Seated Triple Offset	DIMENSIONAL DATA SHEET Series 78 Flanged Torque Seated Triple Offset Butterfly Valve Size 8" - 24"	PART NO.	
PRESSURE RATING ANSI 600		DRAWING NO. FL78-3600	REV B
CUSTOMER/PROJECT		DATE	
SPECIFICATION API 607 6th Edition		1/31/2013	
CERTIFIED BY J.D. & T.Z.			